

| | | |
|----------------------------------|---------|--------|
| CUSTOMER | | |
| ORDER No. | | |
| SERIAL No. | | |
| FRAME SIZE | | |
| Kw | R.P.M. | |
| Hz | PHASE 3 | |
| VOLTS | POLES | |
| BRGS. | D.F. | N.D.F. |
| MOTOR NETT. WT. | Kg. | |
| INSULATION CLASS | | |
| TEMPERATURE RISE °C | | |
| DESIGN AMBIENT TEMPERATURE °C | | |
| HEATER WATTS & VOLTS (IF FITTED) | | |
| - WATTS, - VOLTS | | |

REMARKS
 EEx de IIB
 BASEEFA CERTIFICATE
 No. Ex98E1111X
 or
 EEx de IIC
 BASEEFA CERTIFICATE
 No. Ex98E1112X

ALL DIMENSIONS IN MILLIMETRES

FIRST ANGLE PROJECTION

NOTE:-
 CABLE ENTRY CAN BE SUPPLIED IN ANY ONE OF FOUR POSITIONS AT 90 ° INTERVALS.

NOTE!
 STANDARD MACHINES ARE ARRANGED FOR HORIZONTAL OVERHUNG MOUNTING. CUSTOMERS SHOULD NOTIFY US WHEN ORDERING IF VERTICAL MOUNTING IS REQUIRED. IF VERTICAL, THE MOTOR THRUST BEARING MUST NOT BE ALLOWED TO TAKE ANY LOAD OTHER THAN THE WEIGHT OF THE ROTOR WITHOUT OUR APPROVAL.

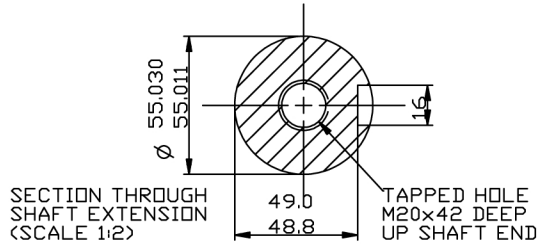

NOTE!
 2.5 ENDPLAY WILL BE PROVIDED FOR ENDTHRUST PROTECTION WHEN CUSTOMERS NOTIFY US OF THEIR INTENTION TO USE RIGID COUPLINGS AND DRIVEN MACHINES WITHOUT ENDPLAY.

OUTLINE DIMENSIONS OF STANDARD FLANGE MOUNTED METRIC A.C. MOTOR TO BS4999 PART 141 T.E.F.V. EEx de TO EN50014/18/19 FRAME W-EF225SN-D (2 POLE ONLY)

| | | |
|----------|-----|--------|
| SCALE | 1:6 | DATE |
| DRAWN | JML | 5/5/97 |
| CHECKED | JML | 5/5/97 |
| APPROVED | IJW | 5/5/97 |

| | | | |
|-----------|--------|------|---------|
| DRG. No. | M70013 | | |
| REVISION: | A M.E | DATE | 30.4.98 |