

BALDOR® • *RELIANCE*

Product Information Packet

CD9105

5HP,1750RPM,DC,256UC,9154D,TEFC,F1

Product Detail							
Revision:	H	Status:	NLA/A	Change #:		Proprietary:	No
Type:	DC	Prod Type:		Elec. Spec:	30WGW206	CD Diagram:	CD0860
Enclosure	TEFC	Mfg Plant:		Mech Spec:	30D042	Layout:	30LYD042
Frame:	256UC	Mounting:	F1	Poles:	4///	Created Date:	
Base:	RG	Rotation:	R	Insulation:	F	Eff. Date:	06-25-2008
Leads:		Literature:		Elec. Diagram:		Replaced By:	
Nameplate NP0668							
CAT.NO.							
SPEC.	30D042W206						
HP	5	ENCL				TEFC	
RPM	1750						
FRAME	256UC	TYPE				SH9154D	
ARM V	180	ARM A				23	
FLD V	200/100	FLD A				1/2	
INSUL	F	AMB.				40C	
DUTY	CONT	SUPPLY				K	
BRG/DE	6208	BRG/ODE				6208	
BRUSHES	8/BP5258A01						
	BLANK						
SER.							
BLANK							
APRV-CSA	Y						

Parts List			
Product ID	Description	Quantity	List Price
SA090930	SA 30D042W206	1.000	
AA008477	AA 30D042W206	1.000	3,677.00
LC0860	CONN. DIAGRAM-DC(SHUNT WOUND MOTOR)	1.000	3.00
BP5258A01SP	BRUSH GRADE E45 90 VOLTS UP, 30 FRAME	1.000	22.00
BP5103	BRUSH SPRING CLIP ASSY (BRA63 LEWIS&BAN	8.000	12.00
10XN4414K20	BOLT, 7/16-14X1-1/4 HH YZ(5)	4.000	2.00
HW1001A44	WASHER,7/16 SPLT LK, ZN	4.000	3.00
11XW1032G06	10-32 X .38, TAPTITE II, HEX WSHR SLTD U	1.000	4.00
HW3001A01	D3019 BRASS WASHER(STIMP)	1.000	3.00
WD1000B17	KPA-8C BURNDY TERMINAL	1.000	4.00
09CB3000SP	CONDUIT BOX CAST	1.000	36.00
09GS1000SP	GASKET-CONDUIT BOX, 1/16 THICK LEXIDE	1.000	4.00
HA6016	ADAPTER, CAST CONDUIT BOX	1.000	9.00
09GS1000SP	GASKET-CONDUIT BOX, 1/16 THICK LEXIDE	1.000	4.00
10XN2520K16	1/4-20 X 1" HX HD SCRW GRADE 5, ZINC P	2.000	4.00
HW1001A25	LOCKWASHER 1/4, ZINC PLT .493 OD, .255 I	2.000	3.00
HA1017A03	INDICATOR RING 9100 DC FRAME (UNCLEANED/	1.000	24.00
51XN1032A24	10-32 X 1 1/2 HX WS SL SR	4.000	3.00
XY1032A02	10-32 HEX NUT DIRECTIONAL SERRATION	4.000	3.00
30EP1900A01	FR EP, MACH 91DC FRAME TEFC	1.000	289.00
HW5100A08	W3118-035 WVY WSHR (WB)	1.000	3.00
30CV5000	INSPECTION BAND ASSY 91DC FRAME ENCLOSED	1.000	21.00
30GS4001	GASKET, INSPECTION BAND	1.000	9.00
10XN2520K20	1/4-20 X 1.25" HX HD SCRWGRADE 5, ZI	1.000	4.00

Parts List (continued)			
Product ID	Description	Quantity	List Price
HW1001A25	LOCKWASHER 1/4, ZINC PLT .493 OD, .255 I	1.000	3.00
XY2520A12	1/4-20 HEX NUT, DIRECTIONAL SERRATIONS	1.000	1.00
30EP1300A01SP	STD FACE MT EP-ENCL-91D & R FRAMES - NEM	1.000	289.00
10XN2520K28	1/4-20 X 1.75" HX HD SCRWGRADE 5, ZINC P	4.000	2.00
HW1001A25	LOCKWASHER 1/4, ZINC PLT .493 OD, .255 I	4.000	3.00
09FN2003A06SP	EXTERNAL FAN, MACH	1.000	85.00
80XN3118A10	5/16-18X5/8 HEX HEAD SET SCREW	1.000	2.00
30FH1000A01	FAN COVER, CAST 91DC FRAME	1.000	163.00
10XN2520K20	1/4-20 X 1.25" HX HD SCRWGRADE 5, ZI	3.000	4.00
HW1001A25	LOCKWASHER 1/4, ZINC PLT .493 OD, .255 I	3.000	3.00
HW1000A25	1/4 SAE FLAT WASHER (FS)	3.000	12.00
09CB3500SP	CONDUIT BOX LID, CAST	1.000	22.00
09GS1001	GASKET-CONDUIT BOX LID, 1/16 THICK LEXID	1.000	9.00
51XW2520A12	.25-20 X .75, TAPTITE II, HEX WSHR SLTD	2.000	3.00
HW2501F24	KEY, 5/16 SQ X 2.750	1.000	5.00
85XU0407A04	#4-7 X 1/4 DRIVE PIN	2.000	3.00
LB1115	LABEL,LIFTING DEVICE (ON ROLLS0	1.000	3.00
MG1000G28SPP	S-9282E CHARCOAL GREY 5GAHAZARDIOUS CHEM	0.019	276.00
30BA1003A01	STD BASE MACH. 9154 DC FRAME - NEMA 256U	1.000	178.00
NP0668	N.P. DC W/BRUSH & BRG PN	1.000	3.00
HA3105A09	THRUBOLT 3/8-16 X 12.000	4.000	5.00
30RK5009A02	ROCKERARM ASSY LESS BRUSHES & BRUSH SPRI	1.000	246.00
LB1125C01	STD (STOCK) CARTON LABEL BALDOR WITH FLA	1.000	3.00
30PA1001	PACK GROUP W/LB5015	1.000	125.00

Parts List (continued)			
Product ID	Description	Quantity	List Price
LB5040	INSTRUCTION TAG, AC & DC	1.000	3.00
LB1119	WARNING LABEL	1.000	3.00

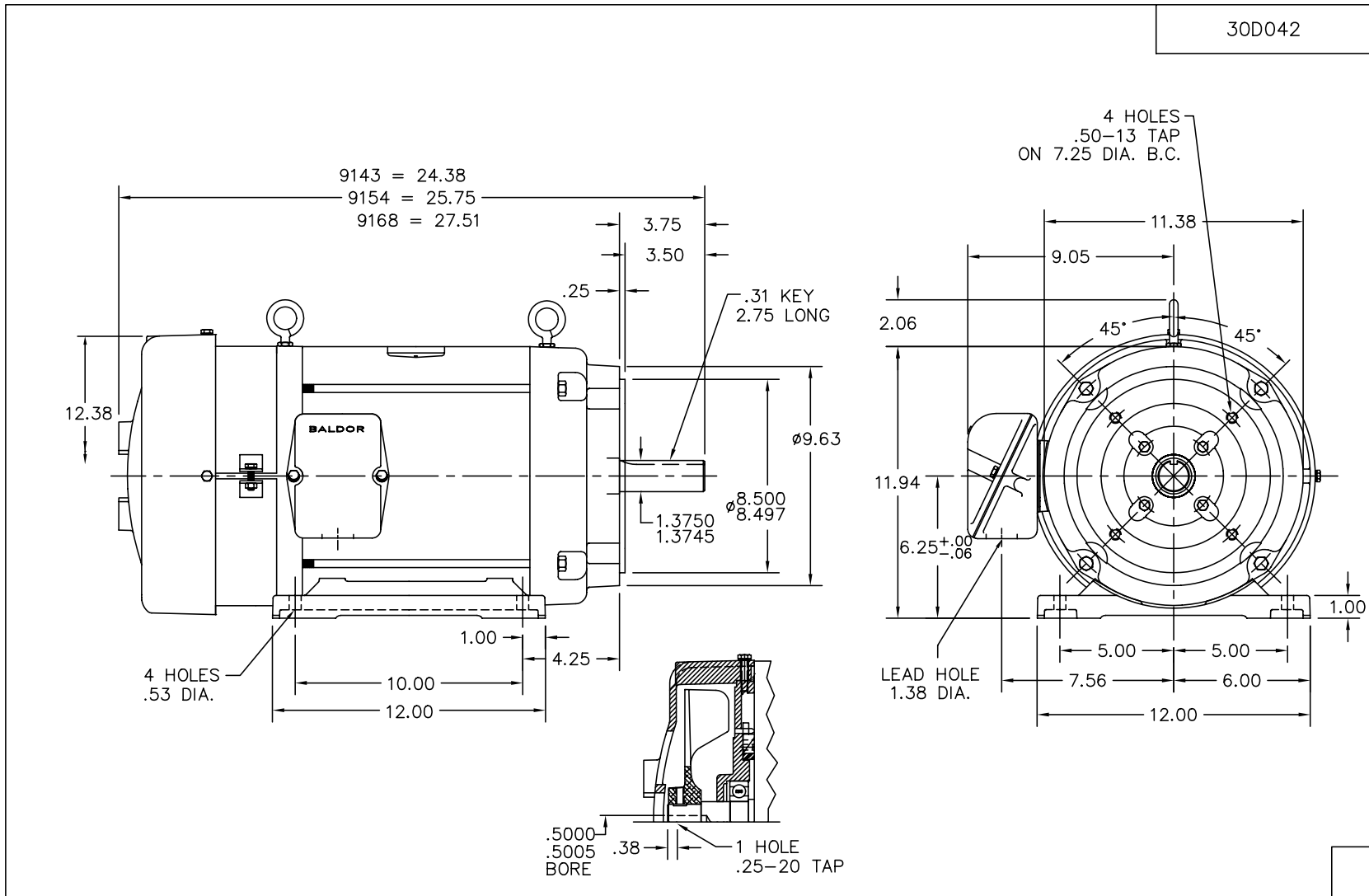

CUST. P.O.		CERTIFIED BY		MODEL		INSUL		AMB	
H.P.	MTG	TYPE	R.P.M.	VOLTS	ENCL	PHASE	FREQ	FRAME	
REMARKS:									
REV:	M	CORRECT STACKING & LENGTH DIM.							
30D042		REF: 30A11	BY: BF	REVISED: 12/08/97	<p style="text-align: center;">BALDOR ELECTRIC Co.</p> <p style="text-align: center;">STD HORZ. 91DC TEFC NEMA 256UC W/M.F.T.K.</p>				
		FILE: AAA00033761	TDR: 0138821						

30D042

CD0860

SH
SHUNT WOUND
4 LEAD

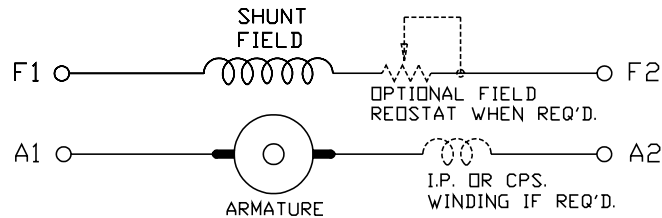

CWDE = +(A1&F1), -(A2&F2)
CCWDE = +(A2&F1), -(A1&F2)

6 LEAD - DUAL VOLTAGE FIELD

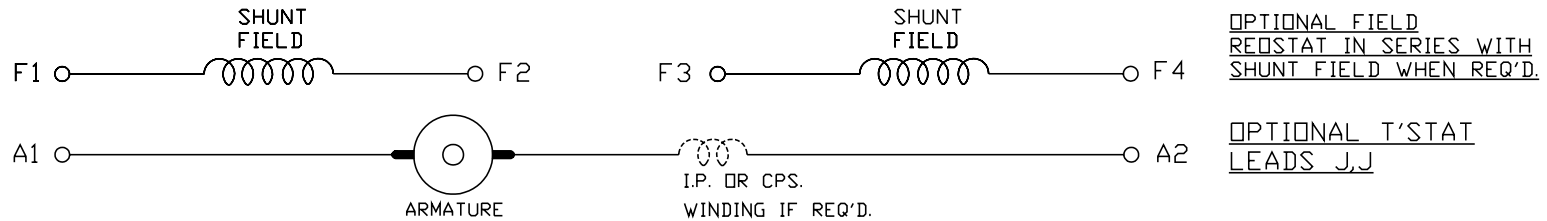

H.V. CWDE = +(A1&F1), (F2&F3), -(A2&F4)
L.V. CWDE = +(A1,F1&F3), -(A2,F2&F4)
CCWDE = REVERSE A1 & A2

LIMIT STARTING INRUSH CURRENT TO NOT MORE THAN 3 TIMES RATED AMPERES BY ENERGIZING THE FULL SHUNT FIELD BEFORE BRINGING THE ARMATURE VOLTAGE UP SLOWLY OR IN STEPS.

MATL: -			
REV:	A	FIXED HATCHING IN DRAWING	
	098000	SCALE: 4.5	BY: WMB
		FILE: AAA00003868	TDR: 0078939
		REVISED: 08/01/95	

BALDOR ELECTRIC Co.

CONNECTION DIAGRAM, SHUNT WOUND, 4 LEAD, 6 LEAD DUAL VOLT.

CD0860